





SPECIFICATION

Product Name: ON/OFF Sensor for Tri-proof Light

Model No.: MC098S 1

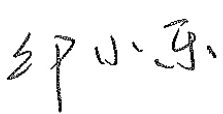
Issue Date: 2020-04-30

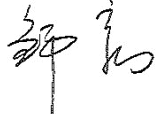
CUSTOMER APPROVED

PRODUCT DIRECTOR APPROVED	SALES CHECKED	R&D CHECKED	PREPARED
			

Shenzhen Merrytek Technology Co.,Ltd

Add: No.17th Building, Dianda Guyuan Industrial Park, Mashantou, Matian, Guangming District, Shenzhen, China, 518106

Tel: +86 (0)755-2305 7253

Fax: +86 (0)755-2786 3012

Website: www.merrytek.com

1. Features

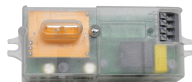

- Ultra-slim design for Tri-proof LED light
- Patented antenna design makes reliable detecting, avoid missing triggered when sensor built-in backside of metal LED plate.
- Adjustable detecting sensitivity via DIP switches, suitable to variety of installation sites.
- Support 6m Max. Mounting height .
- 5 years warranty

2. Parameter

Input	Operating Voltage Range	198-264V AC, 50Hz/60Hz
	Rated Voltage	220-240V AC, 50Hz/60Hz
	Stand-by Power	≤0.5W
	Surge Test	L--N: 1kV
Output	Working Mode	ON/OFF function
	Type of Load	Inductive or Resistive
	Load Capacity	400W(Inductive) ; 800W(Resistive)
	Max. Surge Capacity	30A (50% I_{peak} , $t_{width}=500\mu S$, 230Vac full load, cold start); 60A (50% I_{peak} , $t_{width}=200\mu S$, 230Vac, full load, cold start)
Sensor Parameters	Operating Frequency	5.8 GHz ± 75 MHz , ISM Band.
	Transmitting power	0.5mW Max.
	Hold time	5s//30s/90s/5min/20min/30min
	Detection Sensitivity	100%/75%/50%/25%
	Daylight Sensor	2Lux/10Lux/30Lux/50Lux/Disable
	Detecting Radius	3-10m (mounting height 3-4m) 2-8m(mounting height 6m)
	Mounting Height	6m Max.
	Detecting Angle	150° (Wall mounted), 360° (Ceiling mounted)
Operating Environment	Operating Temperature	-25℃...+60℃
	Storage Temperature	-40℃...+80℃(Humidity: 10%-95% Non-condensing)
Certificate Standards	Safety standards	EN61058-1
	EMC standards	EN300440; EN301489-1; EN55015; EN61547; EN61000-3-2; EN61000-3-3; EN62479
	Environmental Requirement	Compliant to RoHS
	Certificate	CE, RED

Shenzhen Merrytek Technology Co.,Ltd

Add: No.17th Building, Dianda Guyuan Industrial Park, Mashantou, Matian, Guangming District, Shenzhen, China, 518106

Tel: +86 (0)755-2305 7253

Fax: +86 (0)755-2786 3012

Website: www.merrytek.com

Others	Wiring	Press-in Type Terminals, wire diameter : 0.75-1.5mm ²
	IP Rating	IP20
	Protection Class	Class II
	Installation	Built-in
	Dimension	77.5*34.5*22mm
	Package	Bubble bag+Clapboard + Carton (K=A)
	Net Weight	58±2g
	Lifetime	5 years warranty @Ta 230V full load

Note

1. "N/A" means not available.
2. Detection area is effected on volume of motion object and motion speed. The detection area is tested by a 170cm height person and walking speed is 0.3m/s.

3.Function

On/OFF Function

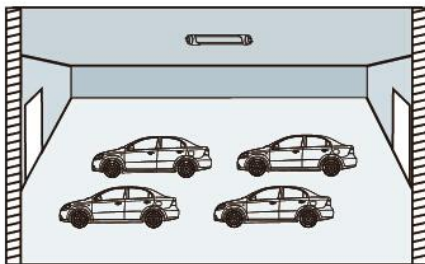

- 1 With sufficient ambient light, the light will not be switched on even if with motion signal.

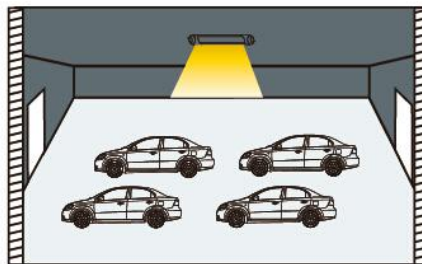

- 2 With insufficient ambient light, the sensor switches on the light when motion is detected.



- 3 After elapse of hold time, the sensor switches off the light when no motion is detected.

4. Dimension (mm)

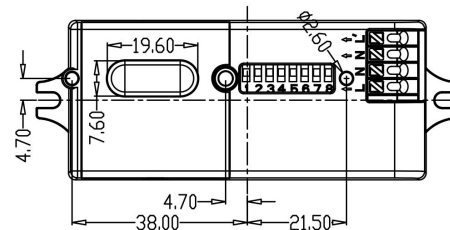
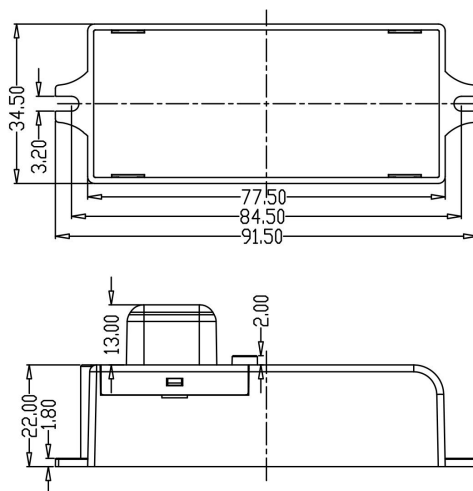

Shenzhen Merrytek Technology Co.,Ltd

Add: No.17th Building, Dianda Guyuan Industrial Park, Mashantou, Matian, Guangming District, Shenzhen, China, 518106

Tel: +86 (0)755-2305 7253

Fax: +86 (0)755-2786 3012

Website: www.merrytek.com

5. Wiring

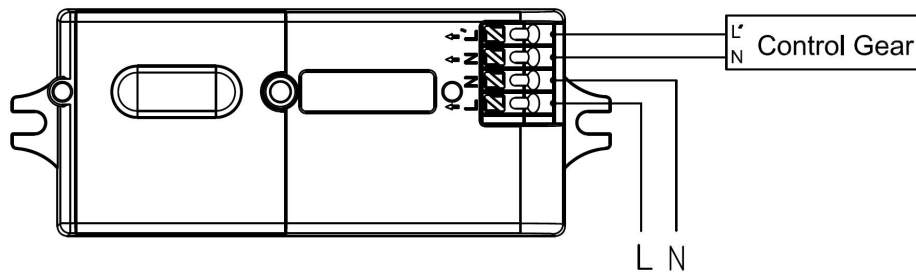

*The sensor is designed for connect one load only. Connect more than one loads may damage the sensor.

6. Structure

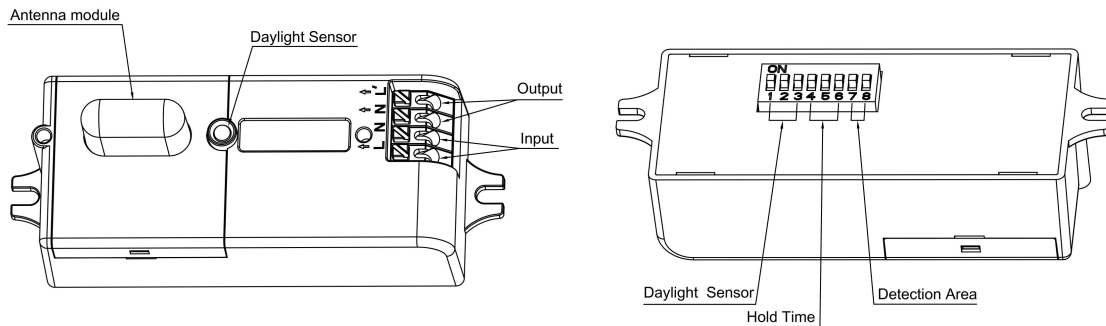

7. Radiation Pattern

1) Ceiling mounting

Ceiling mounted height: 3m
Sensitivity: 100%/75%/50%/25%

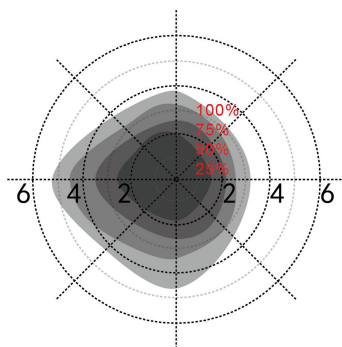

Normal moving (Speed: 1m/s)

Ceiling mounted height: 6m(*)
Sensitivity: 100%/75%

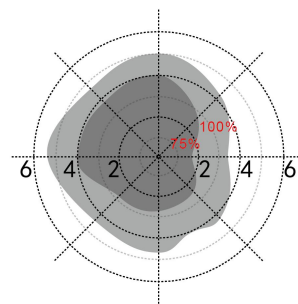

Normal moving (Speed: 1m/s)

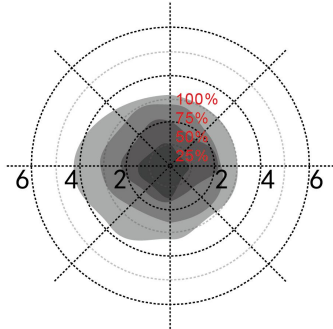

Slow moving (Speed: 0.3m/s)

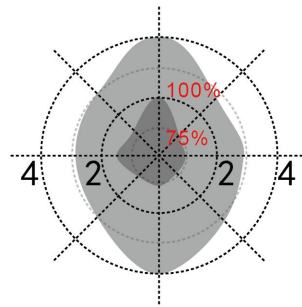

Slow moving (Speed: 0.3m/s)

*Only 100%/75% detection sensitivity is workable when installed at 6m mounting height. 25%/50% sensitivity is not able to detect motion signal.

2) Wall mounting

Horizon mounted height: 2m

Sensitivity: 100%

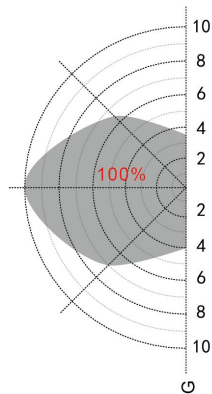

Normal moving (Speed: 1m/s)

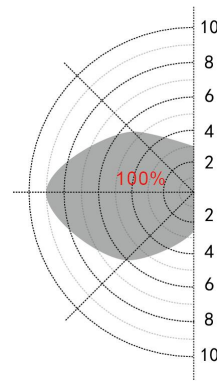

Slow moving (Speed: 0.3m/s)

8. DIP Switch Setting

1) Daylight Sensor

	1	2	3	
I	ON	ON	ON	2Lux
II	-	ON	ON	10Lux
III	-	ON	-	30Lux
IV	-	-	ON	50Lux
V	-	-	-	Disable

Shenzhen Merrytek Technology Co.,Ltd

Add: No.17th Building, Dianda Guyuan Industrial Park, Mashantou, Matian, Guangming District, Shenzhen, China, 518106

Tel: +86 (0)755-2305 7253

Fax: +86 (0)755-2786 3012

Website: www.merrytek.com

2) Hold Time

	4	5	6	
I	ON	ON	ON	5S
II	ON	ON	-	30S
III	ON	-	ON	90S
IV	ON	-	-	5min
V	-	ON	ON	20min
VI	-	-	-	30min

3)Detection Area

	7	8	
I	ON	ON	100%
II	ON	-	75%
III	-	ON	50%
IV	-	-	25%

*Disable” means the daylight sensor not work. it will turn on light once motion is detected regardless of ambient light .

9. Initialization

After power on, the sensor automatically turns on light at 100% brightness. After 10sec, it turns off the light. During the initialization, the sensor is not able to detect movement.

10. Factory Setting

Detection area: 100%, Hold Time: 5S, Daylight Sensor: Disable

11. Application Notice

- The sensor should be installed by a professional electrician. Please turn off the power before installing, wiring, changing the setting of the DIP switch.
- Sensitivity area is related to moving speed of objects, size of moving objects, mounting height, mounting angle, working environment, reflecting materials and etc.. Given detecting area is typical value

Shenzhen Merrytek Technology Co.,Ltd

Add: No.17th Building, Dianda Guyuan Industrial Park, Mashantou, Matian, Guangming District, Shenzhen, China, 518106

Tel: +86 (0)755-2305 7253

Fax: +86 (0)755-2786 3012

Website: www.merrytek.com

that was measured by 165cm/65kg testers in an indoor open environment.

- The detection area of the microwave sensor when installed on the wall will be greatly increased compared to when installed on the ceiling. If adopts wall ceiling, please reduce the sensitivity or contact our company to confirm the usage settings. The daylight thresholds are measured on a sunny day without shadow and in an ambient light diffuse reflection status. Different environment and climate cause different brightness values that daylight sensor measures.
- Sensor parameters may need to be reconfigured in different installation environments, please refer to the following instructions or contact the manufacturer.
- Sensor is for indoor use only. The waterproof effect for outdoor or half-outdoor use will be affected. Wind, rain, and moving objects may cause false triggering.
- The installation height of the sensor product cannot exceed 6 meters, and the optimal height is 3 meters. The distance between the two sensors should be greater than 3m.
- When the sensor is installed in a metal lamp, on a metal reflective surface, or in a small closed environment, the microwave will be reflected multiple times and cause false triggering. Please reduce the sensitivity of the sensor or contact the manufacturer for technical support.
- Please make sure that there are no moving signals such as fans, DC motors, sewer pipes, air outlets, etc. around the sensor, otherwise the sensor may cause false triggering.
- Microwaves cannot penetrate metal. Do not place product in a closed or a half-closed metal lamp. Neither metal nor glass is not allowed to cover above the product.

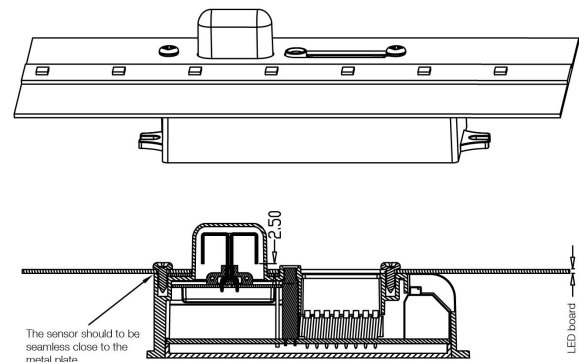
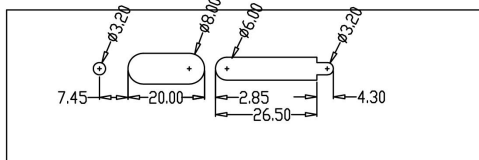

Shenzhen Merrytek Technology Co.,Ltd

Add: No.17th Building, Dianda Guyuan Industrial Park, Mashantou, Matian, Guangming District, Shenzhen, China, 518106

Tel: +86 (0)755-2305 7253

Fax: +86 (0)755-2786 3012

Website: www.merrytek.com